

## Legend

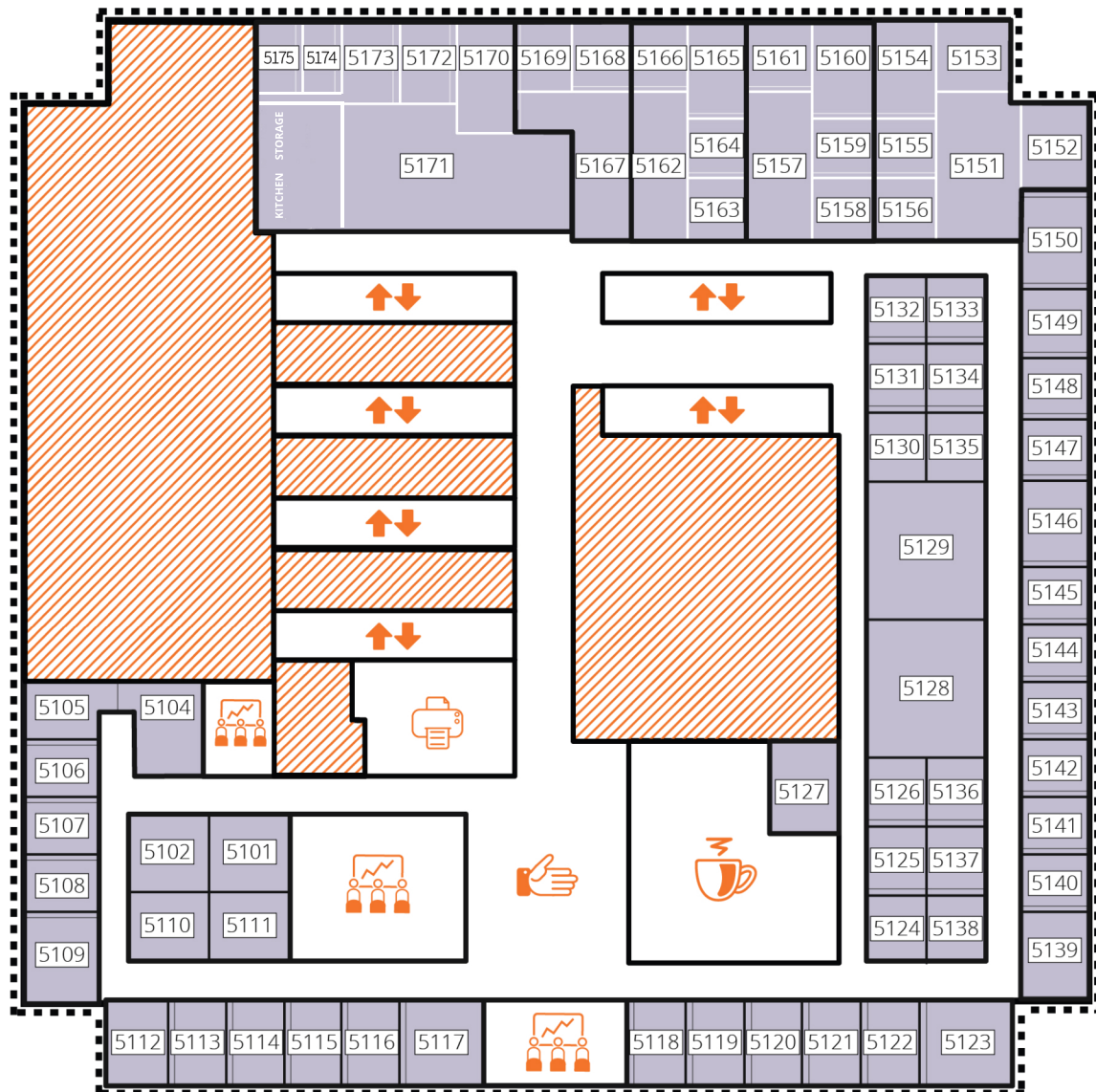

## Amenities

- 24/7 manned building security
- Direct access to Pedway, shuttle to Metra
- On-site fitness center
- Convenient in-building parking with valet
- On-site café
- Steps from The Magnificent Mile

# Meeting Rooms at AON Center

## Member Rates

Non-member rates

| Name            | Description | Capacity | Hourly  | Daily    | Hourly   | Daily    |
|-----------------|-------------|----------|---------|----------|----------|----------|
| Randolph        | Meeting     | up to 20 | 125.00  | \$750.00 | \$145.00 | \$870.00 |
| Millennium Park | Meeting     | up to 12 | \$90.00 | \$540.00 | \$110.00 | \$660.00 |
| Lincoln Park    | Meeting     | up to 6  | \$60.00 | \$360.00 | \$80.00  | \$480.00 |
| Day Office      | Private     | 1 to 2   | \$20.00 | \$120.00 | \$40.00  | \$240.00 |

## Included Amenities



High speed internet access



Self-serve gourmet coffee & filtered water



Flip charts & whiteboards



Pens & stationery pads

## Additional Options

- Full-service catering & beverage service\*
- LCD projector & presentation support
- Audio conferencing
- On-site EV chargers

*All reservations are subject to availability.*

*\*In-room beverage service required for 10+ people.*

*Members: 1 hour minimum reservation. Non-members: 2 hour minimum reservation.*

### *Cancellation Policy:*

*Members can cancel up to 24 hours before the start of the meeting with no charge. Non-members can cancel up to 72 hours before the start of the meeting with no charge. Reservation changes are subject to additional charges.*

*All reservations before 8:30am or after 5:00 pm must be coordinated with a center team member and are subject to additional charges.*